

MLC22

Column Compression Load Cell

MeasureX

Features

- High Measuring Accuracy
- Load Measurement Range of 20t
- Compact and Rugged Model
- Stainless Steel Material
- Welded Sealing



Description

MLC22 series with Stainless Steel material is a rugged and accurate load cell suitable for compression load measurement. This column compression load cell offers great flexibility and reliability for a wide range of applications with highly competitive pricing. Installation of this load cell is easy and it is water and oil-proof. The standard Precision is 0.05% FS. The robust construction of MLC22 with its high performance makes it ideal for demanding long term applications.

Applications

- Electronic scales
- Bin and hopper weighing systems
- Mechanical scale conversion
- Hanging Scales
- OEM scale construction
- Level and inventory measurement

Technical Specifications

- Capacity: 20t
- Output: 1 - 3mV/V
- Precision: 0.05% FS (combined LRH error)
- Creep: $\pm 0.05\%$ FS / 30min
- Overload rating: 150% FS
- Excitation voltage: 5 to 12 VDC
- Zero unbalance: $\pm 1\%$ FS
- Protection: IP66 and option of IP67
- Compensated temp. range: -10 to 55°C
- Operating temp. range: -20 to +65°C
- Temp. coefficient of zero: 0.05% FS /10°C
- Temp. coefficient of span: 0.05% FS /10°C
- Insulation resistance: $\geq 5000\text{M}\Omega$ @ 50VDC
- Input resistance: $380\pm 10\Omega$
- Output resistance: $350\pm 10\Omega$
- Electrical connection: 4-core shielded cable, $\Phi=5.7\text{mm}$ and length=8m and others

Dimensions

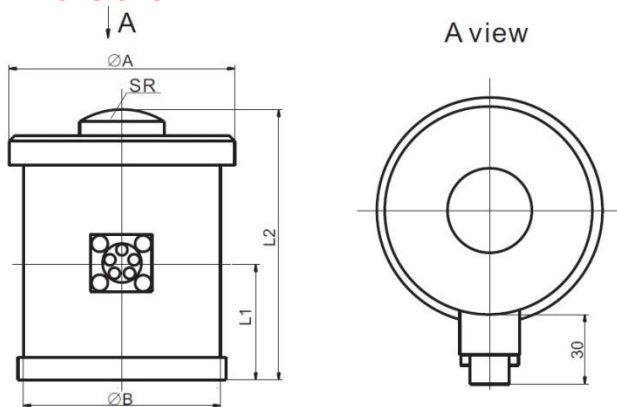

Dimensions are in mm

Wiring



Capacity	ϕA	ϕB	SR	L1	L2
0.5, 1, 2	70	60	15	40	88
3, 6	70	60	20	42	97
10, 20, 30	100	90	30	56	120

Note: All specifications are subject to change without prior notice

Ver. 5.2-20/10